

Stratlock Range

SL-SMT1

The Stratlock SL-SMT1 is a side mounted clip system designed to be used with the Stratlock Rail System (SL-RLE). The SL-SMT1 allows for the installation of Fastmount PanelSafe products or threaded rods while also ensuring secure support for ceiling panels, while allowing for the installation of a suspended ceiling. The SL-SMT1 can also be used to create a standoff wall.

The SL-SMT1 is ideal for commercial interior fit-outs, a wide range of architectural applications, and interior ceiling panels.

The SL-SMT1 is compatible with Fastmount PanelSafe products and threaded rods. This can allow for a static load of up to 50kg (110 lbs) per clip when used to with a threaded rod, offering heavy-duty suspension of interior ceiling panels and wall panels mounted with a standoff.

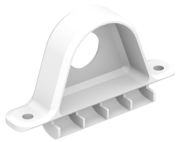

SL-SMT1
STRATLOCK SIDE MOUNT



USE WITH:



PS-150E
PANELSAFE EASY FIT SELF TAPPING
150MM (5 7/8")



PS-S150E
PANELSAFE EASY FIT SURFACE MOUNT
150MM (5 7/8")

APPLICATIONS

- Commercial fit-outs (offices, retail stores)
- Hospitality
- Healthcare
- Education
- Heavyweight ceiling panels
- Stand off wall panels
- Suspended ceilings

**Not suitable for glass and fibre-cement panels.*

FEATURES



Simple Installation

Designed for easy installation while also saving time and reducing re-work.



Compatibility

Works with Fastmount's own PanelSafe products, along with standard threaded rods.



Suspended Ceiling

Enables enhanced flexibility and easy access to utilities and wiring above the ceiling.



Load Capacity

Supports a static load of up to 50kg (110 lbs) per clip when used to suspend a ceiling (using threaded rod).



Heavy-Duty Mounting

Robust fixing, allowing for heavy panel mounting and suitable for heavy duty applications.

Stratlock Range

SL-SMT1

TECHNICAL DATA



SL-FB1
MATERIAL: NYLON

The following table data is based on the below models being used in conjunction with the SL-RLE.

Model	Static Load Capacity
PS-150E	50kg (110lbs) per clip
PS-S150E	50kg (110lbs) per clip

**Products have been tested by a recognized international quality/assurance company. Test reports are available by request. If you are still unsure about panel weight recommendations or would like to confirm any other details regarding panel weights, please contact info@fastmount.com.*

SL-SMT1 CLIP DIMENSIONS

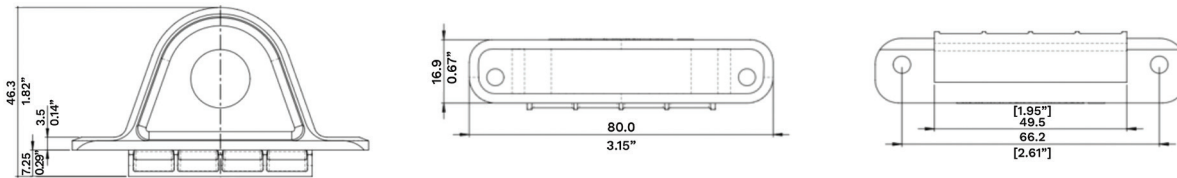

Stratlock Range

SL-SMT1

INSTALLATION OPTIONS

SL-SMT1

The SL-SMT1 is designed to be installed onto the Stratlock rail (SL-RLE).

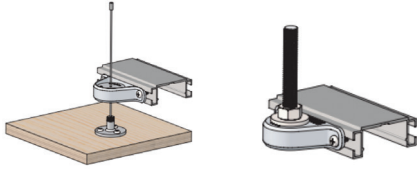

Installed using 2x #8 16mm (5/8") long pan head screws.

INSTALLATION STEPS

INSTALL SL-SMT1 INTO SL-RLE

- 1 Insert SL-SMT1 into SL-RLE.
- 2 Click into place.
- 3 Use #8 screws to fix SL-SMT1 into position.

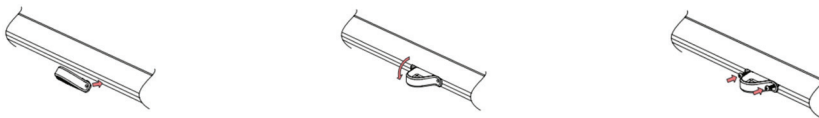

INSTALL PS-S150E USING SL-SMT1

- 4 Pass the PS-150E or PS-S150E through SL-SMT1 and attach to panel with appropriate Stratlock Range clips already installed.
- 5 Clip panel into position.



INSTALL THREADED ROD USING SL-SMT1

- 6 Insert ceiling hanger through SL-SMT1.
- 7 Set bottom M10 nut at correct hanging distance.
- 8 Tighten top nut to lock SL-SMT1 in place and continue panel installation according to Stratlock Range installation guides.

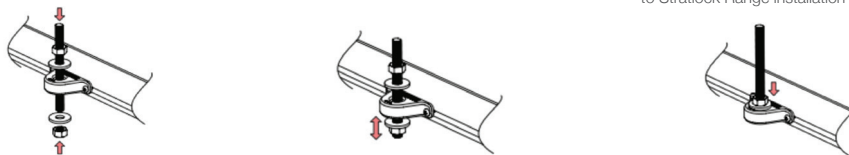

For recommended clip spacings and quantities based on certain panel sizes, please refer to our clip layout guides.

REMOVING PANELS

Fastmount also provide panel removal tools which can help make the removal of panels easier.



CT-05
Stainless steel removal tool, for removing upholstered panels. Requires a minimum gap of 3mm (0.12").



CT-05H
Stainless steel removal tool with fold down hook, for use with lacquered and/or textured panels. Hook requires a minimum gap of 1mm (0.04").



CT-17
Suction cup sucker tool, for removing heavier panels or painted/pre-finished panels. Two required for controlled panel removal.